

REV	LOCATIONS	DESCRIPTION	DATE	REVISER	APPD
1		Dimensions change	07/MAY/19	KATE	FRANK
2		Tolerance change	21/JUN/22	MATT	KATE

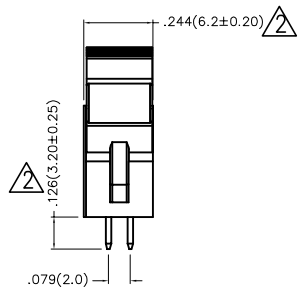
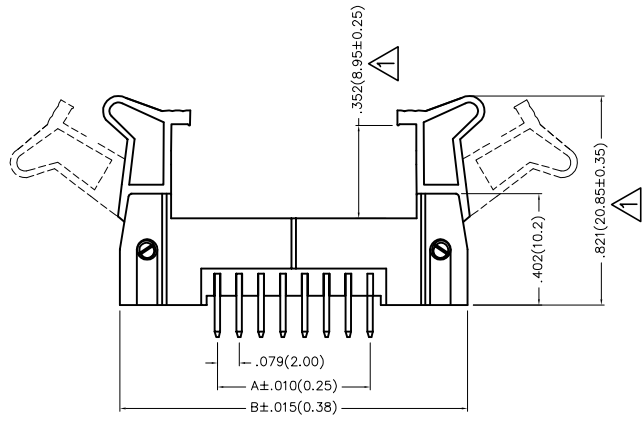
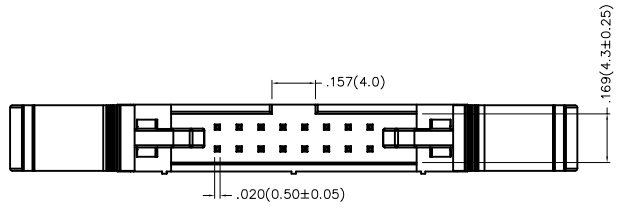

Electrical
 Current Rating: 2.0A AC(rms)/DC
 Voltage Rating: 250V AC(rms)/DC
 Contact Resistance: 20 mΩ Max
 Insulation Resistance: 1000 MΩ MIN
 Withstanding Voltage: 500V AC r.m.s
 Temperature Range—Operating: -40°C~+105°C

Material and Plating
 Housing: Polyester (UL94V-0)
 Contact Pin: Brass
 Plating: Gold Plated/Selective gold in contact area, tin on tail

Ordering Information

FBH 200 07 — D XX S X XX X K6 K
 1 2 3 4 5 6 7 8 9 10 11

1	Category	2	Series Number	3	Distinction No.	4	Row Option	5	Circuits	6	Entry Angle
	FBH-Box Header		200-Pitch 2.00mm		07		D-Double Row		XX		S-180° Vertical
7	Plating	8	Thickness of Plating	9	Material-Resin	10	Color-Resin	11	Packaging		
	1-Gold Plated 3-Selective gold in contact area, tin on tail		00-Gold Plated 05-5μ" Custom plate available		3-LCP 4-PA9T		K6-Black		K-Tray		

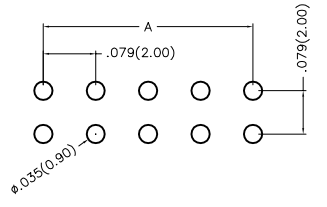

Recommended P.C.Board Layout

Circuits (n)	Part No.	Dimensions(in/mm)		Circuits (n)	Part No.	Dimensions(in/mm)	
		A	B			A	B
10	FBH20007-D10SXXXXK6K	.315(8.00)	.673(26.00)	30	FBH20007-D30SXXXXK6K	1.102(28.00)	1.811(46.00)
12	FBH20007-D12SXXXXK6K	.393(10.00)	1.102(28.00)	34	FBH20007-D34SXXXXK6K	1.260(32.00)	1.969(50.00)
14	FBH20007-D14SXXXXK6K	.472(12.00)	1.181(30.00)	36	FBH20007-D36SXXXXK6K	1.339(34.00)	2.047(52.00)
16	FBH20007-D16SXXXXK6K	.551(14.00)	1.260(32.00)	40	FBH20007-D40SXXXXK6K	1.496(38.00)	2.205(56.00)
20	FBH20007-D20SXXXXK6K	.709(18.00)	1.417(36.00)	44	FBH20007-D44SXXXXK6K	1.654(42.00)	2.362(60.00)
24	FBH20007-D24SXXXXK6K	.866(22.00)	1.575(40.00)	50	FBH20007-D50SXXXXK6K	1.890(48.00)	2.598(66.00)
26	FBH20007-D26SXXXXK6K	.944(24.00)	1.653(42.00)	60	FBH20007-D60SXXXXK6K	2.283(58.00)	2.992(76.00)

 THIRD ANGLE PROJECTION DESIGN UNITS Inch (metric) SCALE 5:1 SIZE A4	GENERAL TOLERANCES (UNLESS SPECIFIED) X.±.012(0.30) X:±5' X.X±.008(0.20) .X:±2' X.XX±.006(0.15) .XX:±1' X.XXX±.004(0.10) .XXX:±0.5'		APPROVE BY FRANK CHECKED BY CHERRY DRAWN BY JACOB	DATE 29/AUG/13 DATE 29/AUG/13 DATE 29/AUG/13	PART NO. FBH20007-DXXSXXXXK6K TITLE Wire to Board(Box Header) Pitch 2.00mm Vertical 180°(DIP)	ITEM NO. FBH20007 REV 2 SHEET NO. 1/1	 Building Technology Cornerstone
	THIS DRAWING CONTAINS INFORMATION THAT IS PROPRIETARY TO TXGA INDUSTRIAL ELECTRONICS(S.Z)CO.,LTD AND SHOULD NOT BE USED WITHOUT WRITTEN PERMISSION						